

EAGLE
GROUP
A Division of AIMCO

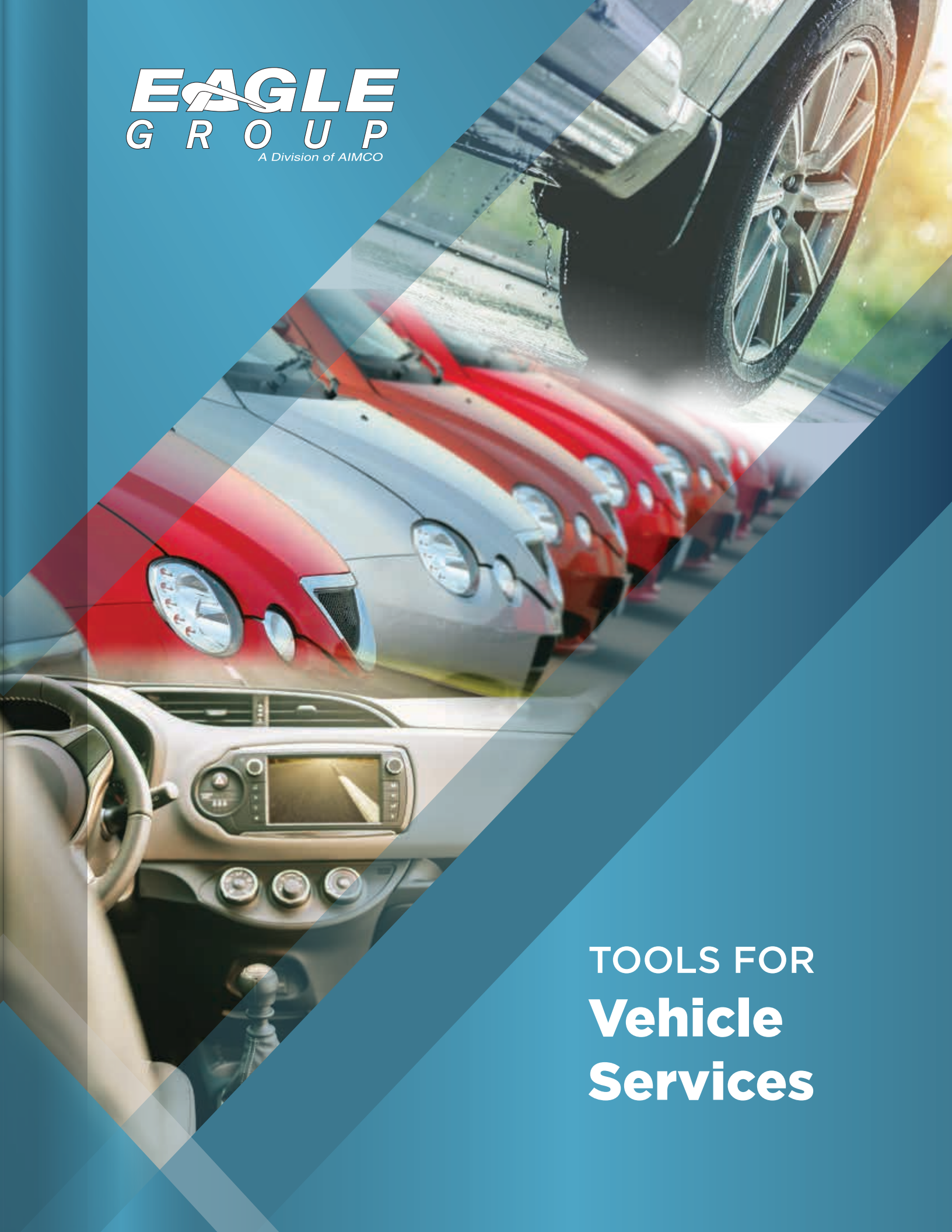

TOOLS FOR
Vehicle
Services

3	GRINDERS & BUFFERS
5	IMPACT WRENCHES
9	RATCHET WRENCHES
11	CUTTING & SPECIALTY TOOLS
15	ACCESSORIES
27	RESOURCES



EAGLE GROUP

A portfolio designed for a variety of customers and customer use requirements

- Economic tool series for limited use, limited maintenance, or limited budget
- Ergonomic series for safer and more comfortable use
- Industrial and Premier series for specific process and safety improvements
- All supported under the AIMCO umbrella of service and support

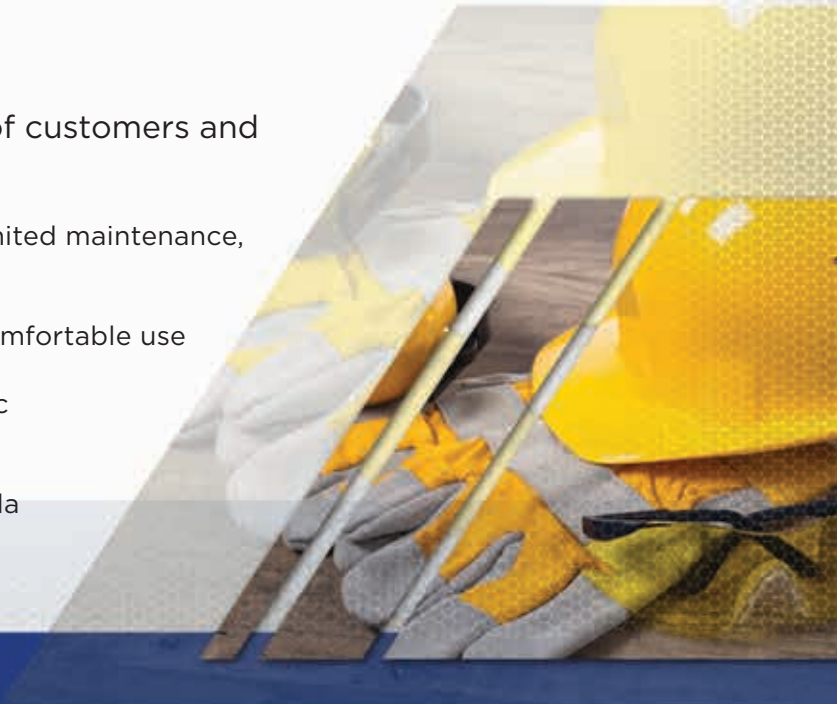

>> ABOUT EAGLE GROUP

Eagle Group is a leading supplier of power tools for industrial markets. Whether you need tools for material removal, finishing, maintenance, automotive, or assembly, Eagle Group has your solution.

Eagle Group has been a supplier of power tools for over 30 years throughout the United States, Mexico, and South America.

Located in Portland, Oregon, Eagle resides in AIMCO's corporate complex.

CALL TODAY TOLL FREE: **(800) 852-1368**

GRINDERS & BUFFERS

GRINDERS & BUFFERS

TOOLS FOR THE TIRE INDUSTRY

UG-60S-29 1/4" 0.50 HP Low-Speed Tire Buffer

- Low speed allows for powerful smooth buffing with no burning or scorching of work surface
- Contoured, ergonomic handle
- Rear muffled exhaust
- Includes spanner wrench to tighten collet



UG-65EBL-ASSY 0.60 HP Horizontal Lightweight Tire Buffer

- Rear muffled exhaust
- Designed for medium-sized tire repair
- Excellent with carbide contour or vane wheels up to 2-1/2"
- Four-bearing construction guarantees long life under heavy usage



USG-4VL 0.60 HP Horizontal Tire Buffer

- Lightweight grinder allows one-hand operation
- Quiet rear exhaust and muffler
- For surface preparation work
- Eliminates heavy shaft drag, dramatically reducing operator fatigue



UG-1250LM 1.0 HP Horizontal Tire Buffer

- Piped away rear exhaust muffles sound and eliminates blowing dust
- Governed motor for fast rubber removal using a cup cutter
- Excellent for inside or outside OTR work and truck rim cleanup with wire brush
- Comes with box muffler and piped away exhaust hose

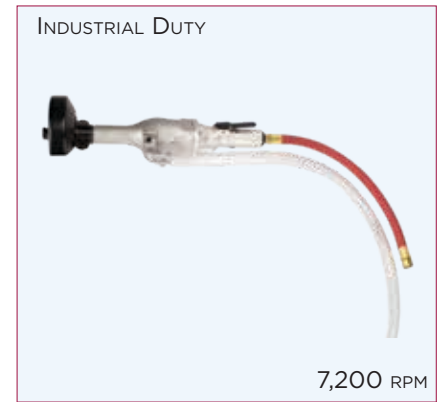

Model	Application	Housing	Collet Size	Capacity (wheel size) in	Approx. Power (hp)	Approx. Speed (rpm)	Throttle Type	Exhaust	Weight		Length		Air Usage (cfm)	Air Inlet
									lb	kg	in	mm		
UG-60S-29	Industrial	Sandcast Aluminum	1/4"	—	0.5	2,900	Lever	Rear	2.3	1.1	8.9	227	18	1/4"
UG-65EBL-ASSY	Industrial	Sandcast Aluminum	—	2.5	0.6	14,600	Lever	Rear	3.1	1.4	10.7	272	22	1/4"
USG-4VL	Industrial	Sandcast Aluminum	—	4	0.6	12,000	Lever	Rear	3.1	1.4	8.7	220	30	1/4"
UG-1250LM	Industrial	Sandcast Aluminum	—	5	1	7,200	Lever	Piped-Away Side	6.2	2.8	17.2	436	32.7	3/8"

IMPACT WRENCHES

IMPACT WRENCHES



From light-duty plant maintenance to heavy-duty industrial steel applications,

Eagle Group impact wrenches are available in single hammer, twin hammer, and pin clutch types.

IMPACT WRENCH CLUTCH INFORMATION

Eagle Group's Impact Wrenches are available with various clutch configurations. Choosing the correct clutch depends on application requirements such as weight, vibration, durability, ease of maintenance, torque, and power.



Single Hammer

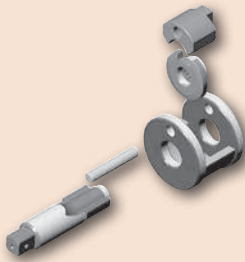

The Single Hammer design is proven and cost effective. It delivers a high torque-to-weight ratio.



Uses

- Standard assembly
- Automotive repair
- Light industrial use

Twin Hammer

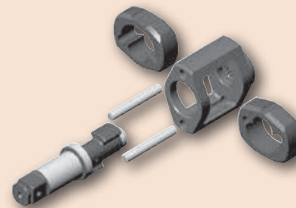

The Twin Hammer design provides a reliable system producing torque quickly with two forged hammers.



Uses

- Industrial maintenance
- Tire service

Pin Clutch

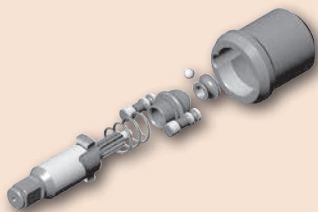

The Pin Clutch design provides rapid delivery of torque and high power-to-weight ratio.



Uses

- Maintenance
- Light assembly
- Hard joints

Swing Hammer

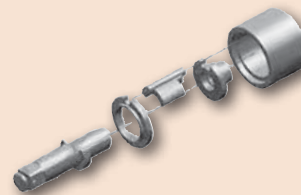

The Swing Hammer Clutch is a simple, effective design that provides rapid delivery of torque.



Uses

- Standard assembly applications
- Maintenance
- Hard joints

3/8" - 1" IMPACT WRENCHES

2010

3/8" Single Hammer Diecast Aluminum Impact Wrench

- Single hammer design
- Air inlet swivels 360° for easy maneuvering
- For bench work, carburetors, ignitions, body panels, transmissions, fender struts, oil pans, and small engine work
- Butterfly throttle allows one-hand directional changes

GENERAL DUTY



WORKING TORQUE: 75 FT-LB

GENERAL DUTY



2260L

WORKING TORQUE: 260 FT-LB

2260L

1/2" Twin Pin Composite Impact Wrench

- Engineered for the after-market automotive industry
- Pin clutch design to quickly deliver torque
- 2-1/2" extended anvil

2P-155034

3/4" Twin Hammer Composite Impact Wrench

INDUSTRIAL DUTY



WORKING TORQUE: 1,000 FT-LB

2P-15501

1" Twin Hammer Composite Impact Wrench



WORKING TORQUE: 1,750 FT-LB

- Extremely lightweight with ergonomic handle configuration
- Proportional trigger for operator control
- Recessed torque output selector in CW direction: Low-Mid-High
- Reverse (CCW) always delivered with maximum power
- Swiveling 360° air inlet
- Reliable 7-vane air motor for consistent power delivery

Model	Application	Housing	Hammer	Drive Size	Approx. Speed (rpm)	Torque Range		Max Torque		Weight		Length		Air Usage (cfm)	Air Inlet
						ft-lb	Nm	ft-lb	Nm	lb	kg	in	mm		
3/8" Wrench															
2010	General	Aluminum	Single	3/8"	10,000	11 - 75	15 - 102	92	125	2.8	1.3	6.4	163	13	1/4"
1/2" Wrench															
2260L	General	Composite	Twin pin	1/2"	7,500	114 - 260	154 - 352	302	409	6.15	2.8	7.5	194	12	1/4"
3/4" Wrench															
2P-155034	Industrial	Composite	Twin	3/4"	6,000	625 - 1,250	850 - 1,690	1,400	1,890	6.7	3.05	8.2	209	7	3/8"
1" Wrench															
2P-15501	Industrial	Composite	Twin	1"	5,000	500 - 2,000	678 - 2,710	2,250	3,050	13	5.9	10	256	12	1/2"

1" - 1-1/2" IMPACT WRENCHES

2450 / 2450L

1" Twin Hammer
Sandcast Aluminum Impact Wrenches

INDUSTRIAL DUTY



WORKING TORQUE: 1,450 FT-LB

- Twin hammer design
- Smooth power in a compact, lightweight design
- 2450 with standard 3" anvil
- 2450L with 6" extended anvil

2463

1" Twin Hammer Steel Impact Wrenches

INDUSTRIAL DUTY



WORKING TORQUE: 1,300 FT-LB

- Twin hammer design
- Steel clutch housing protects hammer mechanism
- For tire changing on trucks and buses
- 6" anvil

INDUSTRIAL DUTY



WORKING TORQUE: 3,000 FT-LB

2S-290015

1-1/2" Pinless Lightweight Heavy-Duty Impact Wrench

- High power-to-weight ratio
- Inside trigger design for safety
- Reversible D handle for ergonomic handling of the tool by right or left handed operators
- Efficient air motor design for best use of air pressure and volume on most job sites

Model	Application	Housing	Hammer	Drive Size	Approx. Speed (rpm)	Torque Range		Max Torque		Weight		Length		Air Usage (cfm)	Air Inlet
						ft-lb	Nm	ft-lb	Nm	lb	kg	in	mm		
1" Wrenches															
2450 2450L	Industrial	Sandcast aluminum	Twin	1"	6,000	940 - 1,450	1,274 - 1,965	1,600	2,169	19	8.5	19.5	495	26	1/2"
2463	Industrial	Steel	Twin	1"	3,900	670 - 1,300	908 - 1,760	1,600	2,169	20.2	9	22	559	26	1/2"
1-1/2" Wrench															
2S-290015	Industrial	Aluminum	Swing	1-1/2"	4,000	750 - 3,000	1,016 - 4,050	3,300	4,455	33.7	15.3	24.4	620	12	1/2"

RATCHET WRENCHES

RATCHET WRENCHES

If you need to reach small bolts in tight places,
Eagle Group's ergonomic ratchet wrenches are the tools you need. These wrenches are ideally suited for light and medium duty industrial and maintenance applications, including body shop work, water pumps, radiators, spark plugs, air conditioning, and light assembly.

>> RATCHET WRENCHES

3115 1/4" Ratchet Wrench

GENERAL DUTY

- Rear exhaust with silencer
- Extended ratchet housing for greater reach
- For smaller fasteners



WORKING TORQUE: 18 FT-LB

GENERAL DUTY



WORKING TORQUE: 55 FT-LB

3105 1/2" Ratchet Wrench

- Excellent for general purpose use
- Improved gear head extends life
- Powerful for tough jobs

3320 1/2" Ratchet Wrench

INDUSTRIAL DUTY

- Excellent for general purpose use
- Improved gear head extends life
- Powerful for tough jobs
- Patented head design for increased durability



WORKING TORQUE: 80 FT-LB

3/8" RATCHET WRENCHES

3100

GENERAL DUTY

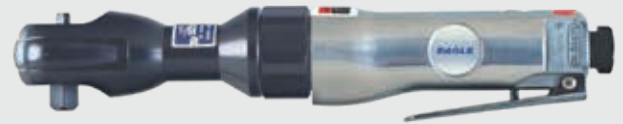

WORKING TORQUE: 24 FT-LB

- Ball & needle bearing construction for long life
- Internal ring gear with three planetary gears

3205

GENERAL DUTY



WORKING TORQUE: 30 FT-LB

- Composite grip for increased operator comfort
- Built-in grease fitting for lubrication ease

3220

INDUSTRIAL DUTY



WORKING TORQUE: 80 FT-LB

- Composite grip for increased operator comfort
- Built-in grease fitting for lubrication ease
- Patented head design for increased durability

Model	Application	Housing	Drive Size	Approx. Speed (rpm)	Approx. Torque		Weight		Length		Air Usage (cfm)	Air Inlet
					ft-lb	Nm	lb	kg	in	mm		
3115	General	Aluminum/steel	1/4"	230	18	24	1.4	0.6	8	203	10	1/4"
3100	General	Aluminum/steel	3/8"	160	24	33	2.6	1.2	10.5	267	16	1/4"
3205	General	Composite/steel	3/8"	160	30	40	2.5	1.1	10.5	267	18	1/4"
3220	Industrial	Composite/steel	3/8"	280	80	109	2.7	1.2	10.9	277	4	1/4"
3105	General	Aluminum/steel	1/2"	150	55	74	3.1	1.4	14.5	368	21	1/4"
3320	Industrial	Aluminum/steel	1/2"	280	80	109	2.7	1.2	10.9	277	4	1/4"

CUTTING & SPECIALTY TOOLS

CUTTING & SPECIALTY TOOLS



Eagle Group offers a variety of speciality tools, including saws, cut-off tools, tire buffers, and blow guns.

PALM BEVELER & SAWS

PALM BEVELER

DL-5216AL Palm Beveler

INDUSTRIAL DUTY

- Lightweight, ergonomic design easily operated with one hand
- Adjustable speed and angle
- Safety lever prevents accidental tool start
- Low vibration
- 360° Exhaust Cover



Model	Application	Approx. Speed (rpm)	Approx. Power (hp)	Beveling Capacity		Dimensions (L x H)		Weight		Air Usage (cfm)	Exhaust	Air Inlet	Noise Level (dbA)
				Steel, Aluminum, Brass 13 Gauge	Stainless Steel 18 Gauge	in	mm	lb	kg				
DL-5216AL	Industrial	30,000	0.25	C0.1 - C2.0 mm	C0.1 - C1.2 mm	5 x 2.5	127 x 63.5	1.06	0.48	15	Rear	1/4"	81

* Mitsubishi inserts part #TCMT080204

6050 Reciprocating Saw

GENERAL DUTY

- High performance motor provides aggressive cutting action
- Insulated handle
- For cutting plastics, fiberglass, and sheet metal



6080 Low-Vibration Reciprocating Saw

INDUSTRIAL DUTY

- 35% longer stroke for "quicker and thicker" material cuts
- Patented vibration-damped cylinder design decreases vibration emission by 40%
- Patented blade guard prevents metal filing from entering the inner mechanism



Model	Application	Housing	Approx. spm	Teeth	Stroke (mm)	Weight		Length		Air Usage (cfm)	Air Inlet
						lb	kg	in	mm		
6050	General	Aluminum	9,500	14 / 24 / 32	10	2.2	1	9.3	236	7	1/4"
6080	Industrial	Aluminum	10,000	24 / 32	14	1.37	0.62	8.9	227	2.3	1/4"

SAWS & CUT-OFF TOOLS

INDUSTRIAL BACK-GOUGING ANGLE SAWS

5A-0514-2
Back-Gouging
Mini Saw



- Industrial-grade and compliant tool design ensures fast and effective back-gouging
- Angle height: 1.75"
- 2" carbide tooth blade (#5A-0514-2CB) sold separately
- For gouging tight access seams

0.5 HP

BLADE SOLD SEPARATELY

5G-10125
5" Angle Saw



1.0 HP

- Left/right hand use
- Governed motor
- Removable base plate
- Side to Side: 31 mm from front blade edge to shoe edge
- Depth Cut Adjustment:
Min: 1/8" (3 mm)
Max: 1" (12.5 mm)



BLADE SOLD SEPARATELY

Model	Application	Housing	Max Blade Diameter	Arbor	Power (hp)	Approx. Speed (rpm)	Max. Blade Exposure	Throttle Type	Exhaust	Weight		Length		Air Usage (cfm)	Air Inlet
										lb	kg	in	mm		
5A-0514-2	Industrial	Steel	2"	3/8"-24	0.5	14,000	—	Lever	Side	3	1.4	8.5	216	15	1/4"
5G-10125	Industrial	Aluminum	5"	5/8"-11	1.0	12,000	0.75"	Lever	Rear	3.95	1.8	11	279	30	3/8"

5205-2EC
3" Cut-Off Tool, 105°

- Ergonomic and safe use design
- 105° angled head design provides improved sight lines and spark angle
- Tight access use
- 1/16" to 1/4" wheel capability



GENERAL DUTY

15,000 RPM

6812EC
3" Cut-Off Tool

- Lightweight and durable ergonomic composite housing with a soft comfortable grip
- Less noise, vibration, and thermal transfer than aluminum tools
- Protective metal guard



INDUSTRIAL DUTY

20,000 RPM

6191
3" Cut-Off Tool

- Rear exhaust directs exhaust air away
- Lock-off throttle prevents accidental start-up
- For cutting muffler clamps, and use in body shops



INDUSTRIAL DUTY

24,000 RPM

Model	Application	Housing	Max. Disc Size	Approx. Speed (rpm)	Weight		Length		Air Usage (cfm)	Air Inlet
					lb	kg	in	mm		
5205-2EC	General	Composite	3"	15,000	1.5	0.68	8.25	210	12	1/4"
6812EC	Industrial	Composite	3"	20,000	1.7	0.77	7.38	187	3	1/4"
6191	Industrial	Aluminum	3"	24,000	2	0.9	8	203	10	1/4"

TOOLS FOR THE TIRE INDUSTRY

UG-60S-29

1/4" 0.50 HP Low-Speed Tire Buffer

- Low speed allows for powerful smooth buffing with no burning or scorching of work surface
- Contoured, ergonomic handle
- Rear muffled exhaust
- Includes spanner wrench to tighten collet



UG-65EBL-ASSY

0.60 HP Horizontal Lightweight Tire Buffer

- Rear muffled exhaust
- Designed for medium-sized tire repair
- Excellent with carbide contour or vane wheels up to 2-1/2"
- Four-bearing construction guarantees long life under heavy usage



USG-4VL

0.60 HP Horizontal Tire Buffer

- Lightweight grinder allows one-hand operation
- Quiet rear exhaust and muffler
- For surface preparation work
- Eliminates heavy shaft drag, dramatically reducing operator fatigue



UG-1250LM

1.0 HP Horizontal Tire Buffer

- Piped away rear exhaust muffles sound and eliminates blowing dust
- Governed motor for fast rubber removal using a cup cutter
- Excellent for inside or outside OTR work and truck rim cleanup with wire brush
- Comes with box muffler and piped away exhaust hose

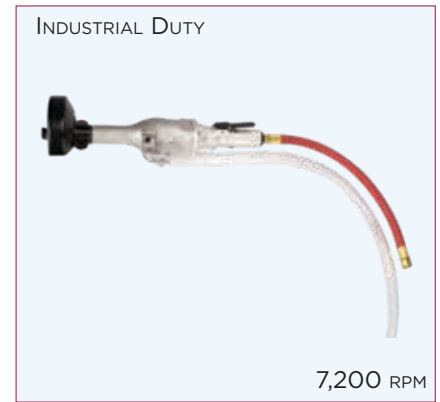

Model	Application	Housing	Collet Size	Capacity (wheel size) in	Approx. Power (hp)	Approx. Speed (rpm)	Throttle Type	Exhaust	Weight		Length		Air Usage (cfm)	Air Inlet
									lb	kg	in	mm		
UG-60S-29	Industrial	Sandcast Aluminum	1/4"	—	0.5	2,900	Lever	Rear	2.3	1.1	8.9	227	18	1/4"
UG-65EBL-ASSY	Industrial	Sandcast Aluminum	—	2.5	0.6	14,600	Lever	Rear	3.1	1.4	10.7	272	22	1/4"
USG-4VL	Industrial	Sandcast Aluminum	—	4	0.6	12,000	Lever	Rear	3.1	1.4	8.7	220	30	1/4"
UG-1250LM	Industrial	Sandcast Aluminum	—	5	1	7,200	Lever	Piped-Away Side	6.2	2.8	17.2	436	32.7	3/8"

ACCESSORIES

ACCESSORIES

*Optimize your
tool's performance*
with Eagle Group's full line
of accessories.

Eagle Group: Your full-service industrial tool source

AUDITOR APTW PRESET TORQUE WRENCHES

Auditor's APTW preset wrenches provide a flexible, easy way to audit fastener torque. A wide range of interchangeable heads provide flexibility and convenience.



- Torque ranges from 5 - 340 Nm
- User friendly, sleek, ergonomic design
- Tactile feedback on achievement of preset torque
- Proprietary adjustment tool guards against unauthorized setting changes
- Wide range of interchangeable heads provide flexibility and convenience
- +/- 3% accuracy when used in clockwise or counterclockwise directions







Wrench Model	Torque Range	Insert Accepted
APTW-25	5 - 25 Nm	12 mm
APTW-50	10 - 50 Nm	12 mm
APTW-100	20 - 100 Nm	12 mm
APTW-150	30 - 150 Nm	12 mm
APTW-200	40 - 200 Nm	14 mm
APTW-340	60 - 340 Nm	14 mm





TORQUE WRENCH INSERTS



Adapters	Description
 APTH-12ADP	9 x 12 M to 14 x 18 F
 APTH-14ADP	14 x 18 M to 9 x 12 F

Ring End Inserts	Description
 APTH-12RE50	1/2" Ring End, 12 mm
 APTH-14RE32	32 mm Ring End, 14 mm

Square Drive Inserts	Description
9 x 12	
 APTH-12SD25	1/4" Sq. Dr.
APTH-12SD38	3/8" Sq. Dr.
APTH-12SD50	1/2" Sq. Dr.
14 x 18	
 APTH-14SD50	1/2" Sq. Dr.

Blank End Inserts	Description
 APTH-12BLANK	12 mm
APTH-14BLANK	14 mm

Open End Head Inserts	Size
	7 mm OE
	8 mm OE

Ratchet Heads	Description
9 x 12	
 APTH-12RT25	1/4" Sq. Dr.
APTH-12RT38	3/8" Sq. Dr.
APTH-12RT50	1/2" Sq. Dr.
14 x 18	
 APTH-14RT50	1/2" Sq. Dr.
APTH-14RT34	3/4" Sq. Dr.

9 x 12	Size	14 x 18	Size	14 x 18	Size
APTH-12OE7	7 mm OE	APTH-14OE1	1" OE	APTH-14OE30	30 mm OE
APTH-12OE8	8 mm OE	APTH-14OE13	13 mm OE	APTH-14OE32	32 mm OE
APTH-12OE9	9 mm OE	APTH-14OE14	14 mm OE	APTH-14OE34	34 mm OE
APTH-12OE10	10 mm OE	APTH-14OE15	15 mm OE	APTH-14OE36	36 mm OE
APTH-12OE11	11 mm OE	APTH-14OE16	16 mm OE	APTH-14OE38	38 mm OE
APTH-12OE12	12 mm OE	APTH-14OE17	17 mm OE	APTH-14OE41	41 mm OE
APTH-12OE13	13 mm OE	APTH-14OE18	18 mm OE	APTH-14OE118	1-1/8" OE
APTH-12OE14	14 mm OE	APTH-14OE19	19 mm OE,	APTH-14OE138	1-3/8" OE
APTH-12OE15	15 mm OE	APTH-14OE21	21 mm OE		
APTH-12OE16	16 mm OE	APTH-14OE22	22 mm OE		
APTH-12OE17	17 mm OE	APTH-14OE24	24 mm OE		
APTH-12OE18	18 mm OE	APTH-14OE25	25 mm OE		
APTH-12OE19	19 mm OE	APTH-14OE27	27 mm OE		
APTH-12OE20	20 mm OE				
APTH-12OE50	1/2" OE				

BALANCERS & RETRACTORS

TW SERIES BALANCERS

TW-0 and TW-00

- Gravity defying / “true balance”
- No tension buildup to cause worker fatigue
- Easy external direct drive tensioning
- 360° upper swivel
- Safety cable provision
- Tool clip included

TW-3 through TW-70

- Tapered drum allows “true balance” throughout cable travel
- Easy external direct drive tensioning
- Cast aluminum casing for durability
- Permanent lubrication
- 360° top swivel
- Enclosed spiral spring for added safety
- Safety chain provision (TW-3 through TW-15 models)
- Automatic safety lock plus manual drum lock (TW-22 through TW-70)



Model	Capacity		Anti-Gravity Capacity (lb)	Cable
	lb	kg		
TW-00	1.1 - 3.3	0.5 - 1.5	2.5 - 3	18" stranded steel cable 1/8 dia.
TW-0	1.1 - 3.3	0.5 - 1.5	2.5 - 3	3.3-ft stranded steel cable 1/8" dia..
TW-3	2.2 - 6.6	1 - 3	4.5 - 6	4.3-ft stranded steel cable 5/32" dia.
TW-5	5.5 - 11	2.5 - 5	8 - 10.5	4.3-ft stranded steel cable 5/32" dia.
TW-9	9.9 - 19.8	4.5 - 9	15 - 19	4.3-ft stranded steel cable 5/32" dia.
TW-15	19.8 - 33	9 - 15	26 - 32.5	4.3-ft stranded steel cable 5/32" dia.
TW-22	33 - 48.4	15 - 22	41 - 48	5-ft stranded steel cable 3/16" dia.
TW-30	48.4 - 66	22 - 30	58 - 65.5	5-ft stranded steel cable 3/16" dia.
TW-40	66 - 88	30 - 40	77.5 - 87.5	5-ft stranded steel cable 3/16" dia.
TW-50	88 - 110	40 - 50	100 - 109.5	5-ft stranded steel cable 3/16" dia.
TW-60	110 - 132	50 - 60	122 - 131	5-ft stranded steel cable 3/16" dia.
TW-70	132 - 154	60 - 70	144 - 153	5-ft stranded steel cable 3/16" dia.

RETRACTORS

RPA Series

- No tools needed to set tension
- 5 ft nylon coated steel cable
- Adjustable cable stop
- Tool clip included
- Model series supports weight range 0.5 - 5 lb
- Reinforced hanging bracket includes safety cable provision

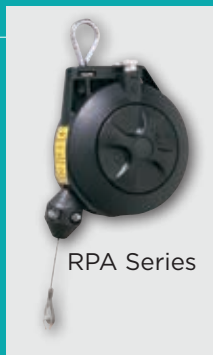

RMA-L Series

- Steel housing with polyester finish
- Ratchet cable lock
- Permanently lubricated
- Tool clip included
- External tension adjustment
- Reinforced hanging bracket includes safety cable provision
- 8 ft of 3/32" diameter coated steel cable

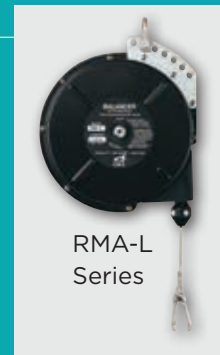

Model	Capacity
RPA-1	0.5 - 1.5 lb 0.2 - 0.7 kg
RPA-2	1.5 - 3 lb 0.7 - 1.4 kg
RPA-3	3 - 5 lb 1.4 - 2.3 kg
RMA-7L	5 - 10 lb* 2.3 - 4.8 kg*
RMA-15L	10 - 15 lb* 4.5 - 6.8 kg*
RMA-20L	15 - 23 lb* 6.8 - 10.4 kg*

* With ratchet lock

BALANCERS & RETRACTORS

ASB-SERIES BALANCERS

- **Built-in Safety Features:** The cable, drum, and enclosed spring are fully visible without opening the unit for easy and convenient safety checks. The sturdy spiral spring is enclosed for greater control and safety
- **Ergonomic Spring Release:** The automatic safety lock provides extra control
- **Extended Cable Length:** Stainless steel cables allow for extended reach on applications
- **Enhanced Gear Mechanism:** Allows for more exact adjustment of tension
- **No Recoil and Low Resistance:** Tapered drum style provides gravity defying tool positioning and low travel



ASB-OC Gravity Defying and Hand Adjustable Balancer



ASB-3C
ASB-5C

Model	Capacity		Stroke		Weight	
	lb	kg	in	cm	lb	kg
ASB-OC	1.1 - 3.3	0.5 - 1.5	51.1	130	1.5	0.7
ASB-3C	3.3 - 6.6	1.5 - 3	86.4	220	3.0	1.4
ASB-5C	5.5 - 11	2.5 - 5	86.4	220	3.4	1.5

LR SERIES LINE REEL BALANCERS

- Designed for light duty applications with small pneumatic tools
- Integrating air hose and support cable keep work areas clean
- Adjustable ball stop for optional positioning
- 1/4" I.D. polyvinyl hose with 1/4" NPT inlet
- 360° upper swivel
- Maximum 142 PSI



LR-09B-90/200

Model	Capacity		Hose Length	
	lb	kg	in	cm
LR-09B-90	3	1.5	35.5 in	90
LR-09B-200	3	1.5	78.3	199

FRL FILTER/REGULATORS

AFRL STACKING FILTERS/REGULATORS

Stacking filter/regulator combinations provide air filtration and precise regulation in a single unit for easy mounting and installation.

- All models include L-mount bracket, gauge, and metal bowl shields
- Polycarbonate filter and lubricator bowls (metal bowls standard on AFRL-8)
- 25-micron filter included on all models
- Regulating range: 7 - 125 PSI
- Custom order upgrade items include metal bowl, 5 micron filter, semi-automatic filter drain, and reduced PSI range regulator. Contact an Eagle Group Customer Service Associate for more information, (503) 254-6600, or toll free (800) 852-1368
- Maximum allowable Input Pressure not to exceed 120 PSI



AFRL-2-C
AFRL-3-C



AFRL-3
AFRL-4
AFRL-8

Model	Port	Gauge Port	Flow Rate		Bowl Shield
			CFM	l/min	
AFRL-2	1/4"	1/8"	70	2,000	yes
AFRL-2-C	1/4"	1/8"	60	1,700	yes
AFRL-3	3/8"	1/4"	140	4,000	yes
AFRL-3-C	3/8"	1/4"	105	3,000	yes
AFRL-4	1/2"	1/4"	140	4,000	yes
AFRL-8	1"	1/4"	180	5,000	yes

Dimensions

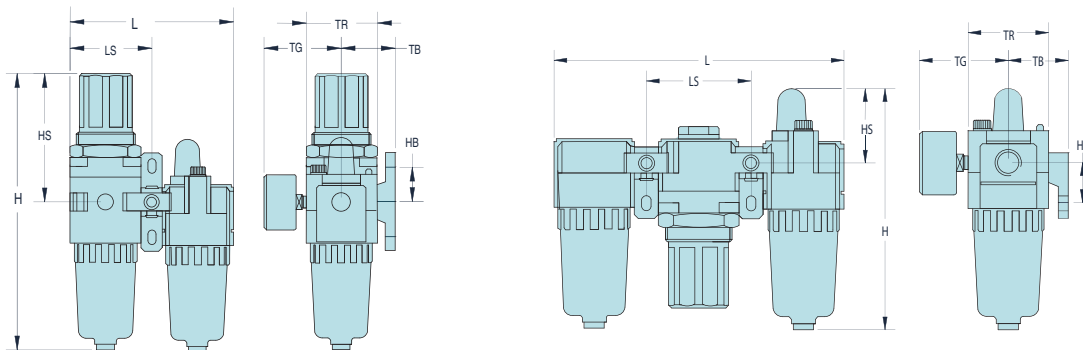

Model	H in/mm	HB in/mm	HS in/mm	L in/mm	LS in/mm	TB in/mm	TG in/mm	TR in/mm
AFRL-2	6.16 (156.5)	1.39 (35.3)	1.50 (38.1)	7.13 (181.1)	2.52 (64)	1.61 (41)	2.39 (60.7)	2.09 (53.1)
AFRL-2-C	8.31 (211.1)	1.38 (35.1)	3.64 (92.5)	4.61 (117.1)	2.30 (58.4)	1.61 (40.9)	2.39 (60.7)	2.09 (53.1)
AFRL-3	7.54 (191.5)	1.57 (40)	1.61 (40.9)	9.37 (238)	3.31 (84.1)	1.97 (50)	2.58 (65.5)	2.76 (70.1)
AFRL-3-C	10.31 (261.9)	1.57 (39.9)	4.41 (112)	6.06 (153.9)	3.03 (77)	1.97 (50)	2.58 (65.5)	2.76 (70.1)
AFRL-4	7.54 (191.5)	1.57 (40)	1.61 (40.9)	9.37 (238)	3.31 (84.1)	1.97 (50)	2.58 (65.5)	2.76 (70.1)
AFRL-8	10.69 (271.5)	1.97 (50)	1.89 (48)	11.81 (300)	4.13 (104.9)	2.75 (69.9)	2.97 (75.4)	3.54 (89.9)

POLYURETHANE AIR HOSE

Single Air Hose Assemblies (Coiled)

- Durable Polyurethane is chemical resistant and lightweight, and provides excellent recoil memory and maximum flexibility
- Available in transparent hose color (opaque also available)
- Assemblies for coiled hose include reusable swivel fitting. Straight hose available with or without fittings
- Working temperature: -104° F to 175° F

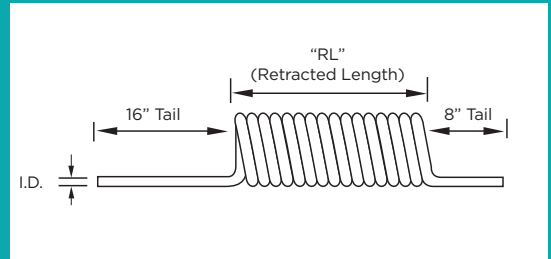

Model	Size (O.D. x I.D. x Length)	Retracted Length	Working Pressure	NPT Fittings
ASH-250C-10MSZ	3/8" x 1/4" x 10'	7"	100 psi	1/4"
ASH-250C-15MSZ	3/8" x 1/4" x 15'	9-1/2"	100 psi	1/4"
ASH-250C-25MSZ	3/8" x 1/4" x 25'	15-1/2"	100 psi	1/4"
ASH-375C-15MSZ	9/16" x 3/8" x 15'	10"	100 psi	3/8"
ASH-375C-25MSZ	9/16" x 3/8" x 25'	14"	100 psi	3/8"
ASH-500C-15MSZ	3/4" x 1/2" x 15'	13"	100 psi	1/2"
ASH-500C-25MSZ	3/4" x 1/2" x 25'	23"	100 psi	1/2"

Custom length coil assemblies and special colors available in minimum order quantities. Contact an Eagle Group Customer Service Associate, (503) 254-6600, or toll free (800) 852-1368.

Straight Air Hose

- Sold per foot
- For full-reel pricing, contact an Eagle Group Customer Service Associate, (503) 254-6600, or toll free (800) 852-1368.



Model	I.D.
ASH-375Z	3/8"
ASH-500Z	1/2"

RUBBER HOSE

- Designed for use in a wide range of industrial, construction, and agricultural applications
- Constructed of high grade, reinforced EPDM synthetic rubber
- Working temperature: -40° F to 190° F



I.D.	O.D.	Length	Working Pressure	Weight
3/16"	0.44"	10 ft	200 psi	0.8 lb
1/4"	0.5"	10 ft	200 psi	0.9 lb
5/16"	0.58"	10 ft	200 psi	1.2 lb
3/8"	0.67"	10 ft	200 psi	1.5 lb
1/2"	0.81"	10 ft	200 psi	2.0 lb
5/8"	0.97"	10 ft	200 psi	2.7 lb
3/4"	1.12"	10 ft	200 psi	3.4 lb

Custom lengths available. Contact an Eagle Group Customer Service Associate, (503) 254-6600, or toll free (800) 852-1368.

AIR LINE ACCESSORIES

BRASS QUICK COUPLERS

Manual ball couplers designed for use with ergonomic twist plugs. Brass with nitrile seals, rated to 300 PSI, from -40° to +250° F.

Model	Description
B23	1/4" NPT F x 1/4" QC
B23E	1/4" NPT F x 3/8" QC
B25	3/8" NPT F x 3/8" QC



ERGONOMIC TWIST PLUGS



These unique, ergonomically designed hose fittings provide 360° rotation and 35° angled rotation in any direction.

- Two rotation points prevent kinking of air hose
- Design ensures full air pressure flow
- Rotating joint has polyurethane dust cover
- Heavy-duty construction

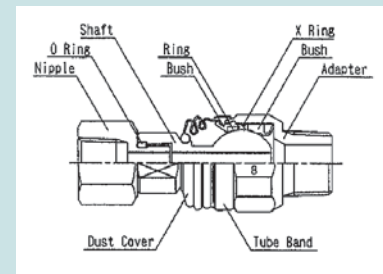

Model	Description
TS-30NP-2NPT	3/8" NPT Female x 1/4" NPT Male
TS-20NP-2NPT	1/4" NPT Female x 1/4" NPT Male
TS-20US-2NPT	1/4" US Plug x 1/4" NPT Male
TS-30US-3NPT	3/8" US Plug x 3/8" NPT Male

MINI AIR GAUGE SWIVEL JOINT KITS

- Bi-directional 360° rotation
- Keeps air hose straight and untwisted
- Decreases operator fatigue



Model	Inlet	Weight	Max PSI	Tool CFM
7021AG	1/4" NPT	3 oz	Up to 125	25
7041AG	3/8" NPT	3 oz	Up to 125	50

SWIVEL AIR FITTINGS

For use with most portable air tools, including grinders, drills, screwdrivers, buffers, sanders, staple guns, and more. Rotates 360° for awkward angles.

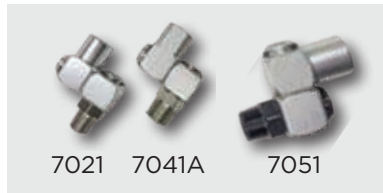

Model	Inlet	Weight	Max PSI	Tool CFM
7021	1/4" NPT	3 oz	Up to 125	25
7041A	3/8" NPT	11 oz	Up to 125	50
7051	1/2" NPT	7 oz	Up to 125	60

BRASS ADAPTERS AND BUSHINGS



Pipe fittings for use as medium and low pressure connectors. Meets functional requirements of SAE J530, SAE J531, ASME and ASA. Rated 1,000 PSI from -65° to +250° F.

Model	Description
222P-6-4	3/8" NPT F x 1/4" NPT M Adapter
222P-8-6	1/2" NPT F x 3/8" NPT M Adapter
222P-12-8	3/4" NPT F x 1/2" NPT M Adapter
209P-6-4	1/4" NPT F x 3/8" NPT M Bushing
209P-8-6	3/8" NPT F x 1/2" NPT M Bushing

AIR LINE FITTINGS

Model	Description
375-RZ	1/4" NPT Rigid Fitting
250-RZ	1/4" NPT Swivel Fitting
375-SZ	3/8" NPT Rigid Fitting
250-SZ	3/8" NPT Swivel Fitting
500-SZ	1/2" NPT Swivel Fitting

BITS & SOCKETS

STANDARD FASTENER TOOLS

Connect your tool to the application with Bits, Sockets, and Nutsetters from AIMCO.

AIMCO has assembled a complete package of commonly used screwdriver bits and nutsetters. Our goal is to supply you with the highest quality bits and nutsetters for your fastener needs. Whether you're in electronics, aerospace, automotive, or general industry, AIMCO has the bits and nutsetters to fit your needs.

MAG-O-NETS: A REVOLUTIONARY WAY TO CONVERT STANDARD BITS TO MAGNETIC BITS



- Easy, cost effective alternative to traditional magnetic bit holder and insert bit combination
- Improves torque transfer by eliminating "wobble effect"
- Easily adjust magnetic attraction by moving Mag-O-Net collar closer to or further from fastener
- Fits virtually any standard screwdriver bit
- Reusable and interchangeable — once a bit is worn out, simply remove your Mag-O-Net and slide it onto the next bit
- Lifetime guarantee on magnetic attraction

Part #	ID	OD	L
AM1/4Z	7 mm	19 mm	10 mm
AM5Z	6 mm	17.5 mm	10 mm
AM3/16Z	3/16 in	17.5 mm	10 mm

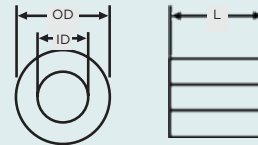

MARKER SOCKETS

Marker Sockets paint the bolt head at the same time the torque is checked. Sockets are designed to your specification.

- Unit consists of a marker socket, an ink cartridge, a spring, and the cartridge cap
- Cartridge can be inserted/taken off easily for ink management
- Easily replaceable paint point
- Can be used with either oil-based or water-based inks
- When ordering, provide dimensions shown. To order, contact an Eagle Group Customer Service Associate (503) 254-6600, or toll free (800) 852-1368



Marker Socket
MARK-XXXX



Ink cartridge

Socket



Bolt



Nut



Recessed bolt

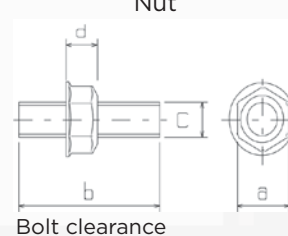
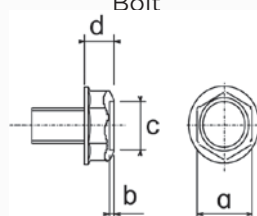

Bolt clearance

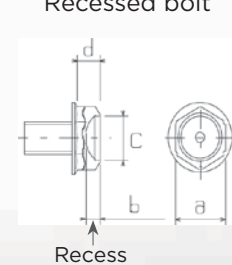

Recess

BITS & SOCKETS

IMPACT SOCKETS

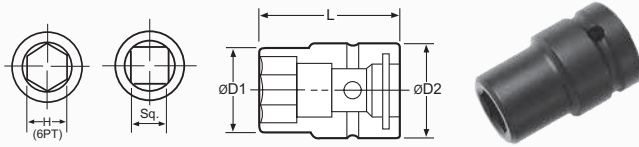

Part #	Hex	D1		D2		L	
		mm	in	mm	in	mm	in

3/8" Square Drive							
SAE	A31/4	1/4"	10	0.39	19	0.75	34 1.34
	A35/16	5/16"	12	0.47	19	0.75	34 1.34
	A33/8	3/8"	15	0.59	19	0.75	34 1.34
METRIC	A306	6 mm	10	0.39	19	0.75	34 1.34
	A307	7 mm	13	0.49	20	0.79	32 1.26
	A308	8 mm	14	0.55	20	0.79	32 1.26

3/8" Square Drive, Deep							
	A307-2	7 mm	13	0.49	20	0.79	50 1.97
	A307-2.75	7 mm	13	0.49	20	0.79	70 2.76
	A308-2	8 mm	14	0.55	20	0.79	50 1.97

3/8" Square Drive, Magnetic							
SAE	A31/4MP	1/4"	10	0.39	19	0.75	34 1.34
	A35/16MP	5/16"	12	0.47	19	0.75	34 1.34
	A33/8MP	3/8"	15	0.59	19	0.75	34 1.34
METRIC	A308MP	8 mm	14	0.55	20	0.79	32 1.26
	A310MP	10 mm	17	0.65	20	0.79	32 1.26
	A311MP	11 mm	17	0.65	19	0.75	34 1.34

1/2" Square Drive							
SAE	A43/8	3/8"	16	0.63	25	0.98	38 1.50
	A47/16	7/16"	18	0.69	25	0.98	38 1.50
	A41/2	1/2"	19	0.75	25	0.98	50 1.97
METRIC	A408	8 mm	16	0.61	25	0.98	40 1.58
	A409	9 mm	16	0.63	25	0.98	40 1.58
	A410	10 mm	18	0.69	25	0.98	40 1.58

Part #	Hex	D1		D2		L	
		mm	in	mm	in	mm	in

1/2" Square Drive, Deep							
SAE	A43/8-3.25	3/8"	17	0.67	25	0.98	82 3.23
	A47/16-3.25	7/16"	19	0.73	25	0.98	82 3.23
	A41/2-3.25	1/2"	22	0.85	25	0.98	82 3.23
METRIC	A410-2	10 mm	18	0.69	25	0.98	50 1.97
	A410-3	10 mm	18	0.69	25	0.98	75 2.95
	A410-3.25	10 mm	17	0.67	25	0.98	82 3.23
	A411-3.25	11 mm	19	0.73	25	0.98	82 3.23

1/2" Square Drive, Magnetic							
	A408MP	8 mm	16	0.61	25	0.98	40 1.58
	A410MP	10 mm	18	0.69	25	0.98	40 1.58
	A412MP	12 mm	21	0.81	25	0.98	40 1.58

3/4" Square Drive							
SAE	A611/16	11/16"	30	1.18	44	1.73	50 1.97
	A63/4	3/4"	32	1.26	44	1.73	50 1.97
	A613/16	13/16"	35	1.38	44	1.73	50 1.97
METRIC	A614	14 mm	24	0.95	38	1.50	55 2.17
	A616	16 mm	27	1.06	44	1.73	50 1.97
	A617	17 mm	30	1.18	38	1.50	55 2.17

3/4" Square Drive, Deep							
SAE	A611/16-4	11/16"	31	1.22	44	1.73	100 3.94
	A63/4-4	3/4"	33	1.30	44	1.73	100 3.94
	A613/16-4	13/16"	36	1.42	44	1.73	100 3.94
METRIC	A617-4	17 mm	31	1.22	44	1.73	100 3.94
	A618-4	18 mm	32	1.26	44	1.73	100 3.94
	A619-4	19 mm	33	1.30	38	1.50	100 3.94

1" Square Drive							
SAE	A87/8	7/8"	37	1.46	54	2.13	59 2.32
	A815/16	15/16"	38	1.50	54	2.13	59 2.32
	A81	1"	41	1.61	54	2.13	59 2.32
METRIC	A817	17 mm	31	1.22	50	1.97	63 2.48
	A819	19 mm	33	1.30	50	1.97	63 2.48
	A821	21 mm	37	1.46	50	1.97	63 2.48

ANTI-MARRING SOCKETS

AIMCO's anti-marring sockets have a protective resin cover that spins freely, preventing damage to application surfaces, and protecting fingers.

To order sockets specific to your application, contact an Eagle Group Customer Service Associate (503) 254-6600, or toll free (800) 852-1368



CV Series



CVF Series



CVF Series with Bit Attachment



BITS & SOCKETS

Allen Sockets

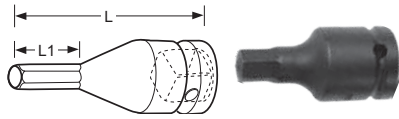

Part #	Hex	L1		L	
		mm	in	mm	in

3/8" Square Drive

A31/4C	1/4"	10	0.39	42	1.65
A304C	4 mm	10	0.39	42	1.65

1/2" Square Drive

A41/4C	1/4"	25	0.98	50	1.97
A405C	5 mm	25	0.98	50	1.97

Universal Sockets

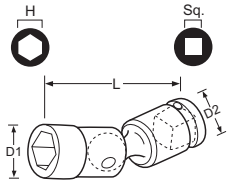

Part #	Hex	D1		D2		L	
		mm	in	mm	in	mm	in

3/8" Square Drive

A310U	10 mm	16	0.63	20	0.79	55	2.17
A311U	11 mm	16	0.63	20	0.79	60	2.36

1/2" Square Drive

A412U	12 mm	20.5	0.81	25	0.98	70	2.76
A413U	13 mm	19	0.75	24	0.95	70	2.76

Extensions

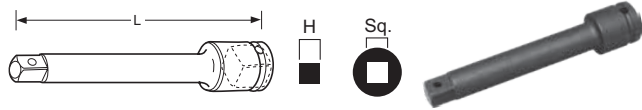

Part #	Sq. Drive		L		D	
	Hex	mm	mm	in	mm	in
A375E	3/8"	3/8"	75	2.95	20	0.79
A405E	1/2"	1/2"	51	2.01	30	1.18
A610E	3/4"	3/4"	100	3.94	44	1.73
A810E	1"	1"	102	4.02	54	2.13
A1220E	1-1/4"	1-1/4"	200	7.87	60	2.36
A1418E	1-1/2"	1-1/2"	178	7.01	84	3.31
A2426E	2-1/2"	2-1/2"	264	10.39	137	5.39

Socket Adapters

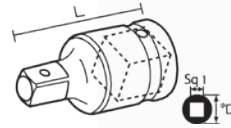

Part #	Female	Male	D		L	
	Sq. Drive	Sq. Drive	mm	in	mm	in
A302A	3/8"	1/4"	22	0.87	35	1.38
A403A	1/2"	3/8"	25	0.98	37	1.46
A504A	5/8"	1/2"	35	1.38	47	1.46
A604A	3/4"	1/2"	38	1.50	53	2.09
A806A	1"	3/4"	50	1.97	70	2.76
A128A	1-1/4"	1"	60	2.36	76	2.99
A#508A	Spline #5	1"	60	2.36	90	3.54

Nutsetters

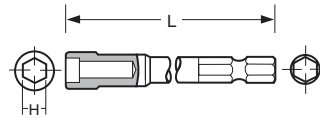

Part #	Hex	L	
		mm	in
A3B1/4-2	1/4"	50	1.97
A3B1/4-2.5	1/4"	63	2.50
A3B5/16-2	5/16"	50	1.97
A3B5/16-2.5	5/16"	63	2.50
A3B3/8-2	3/8"	50	1.97
A3B3/8-2.5	3/8"	63	2.50
A3B05-2.75	5 mm	70	2.76
A3B55-1.2	5.5 mm	30	1.18
A3B55-2.75	5.5 mm	70	2.76
A3B55-4	5.5 mm	100	3.94
A3B06-2.75	6 mm	70	2.76
A3B07-1.2	7 mm	30	1.18
A3B07-2	7 mm	50	1.97
A3B07-2.75	7 mm	70	2.76
A3B07-4	7 mm	100	3.94
A3B08-1.2	8 mm	30	1.18
A3B08-2	8 mm	50	1.97
A3B08-2.75	8 mm	70	2.76
A3B08-4	8 mm	100	3.94
A3B08-6	8 mm	150	5.91
A3B08-8	8 mm	200	7.87
A3B09-2.75	9 mm	70	2.76
A3B09-4	9 mm	100	3.94
A3B10-1.2	10 mm	30	1.18
A3B10-2	10 mm	50	1.97
A3B10-2.75	10 mm	70	2.76
A3B11-2.75	11 mm	70	2.76
A3B12-1.2	12 mm	30	1.18
A3B13-2.75	13 mm	70	2.76
A3B14-2.75	14 mm	70	2.76
A3B16-2.75	16 mm	70	2.76
A3B17-2.75	17 mm	70	2.76

BITS & SOCKETS

Quick Change Chucks



Part #	Sq. Drive	Hex	D1		L	
			mm	in	mm	in
ADC-2S	1/4"	1/4"	19	0.75	38	1.50
ADC-3S	3/8"	1/4"	20	0.79	42	1.65
ADC-4S	1/2"	1/4"	19	0.75	46	1.81
ADC-3SH7/16Z	3/8"	7/16"	25	0.98	46	1.81
ADC-4SH7/16Z	1/2"	7/16"	33	1.30	55	2.17

Phillips Insert Bits

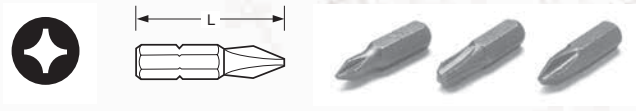

Part No	Point Size	L	
		mm	in
A38S2-1	2	25	0.98
A38S3-1	3	25	0.98

Phillips Single-Ended Power Bits

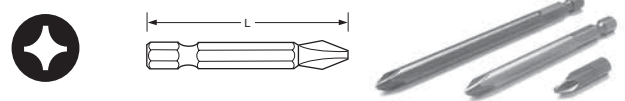

Part #	Point Size	L	
		mm	in
A3S0-2	0	50	1.97
A3S1-2	1	50	1.97
A3S1-2.75	1	70	2.76
A3S1-3	1	75	2.95
A3S1-3.5	1	90	3.54
A3S1-4	1	100	3.94
A3S1-6	1	150	5.91
A3S2-1.2	2	30	1.18
A3S2-1.6	2	40	1.57
A3S3-2	3	50	1.97
A3S3-2.75	3	70	2.76

Square Recess Bits

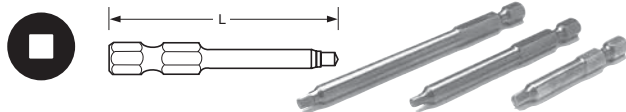

Part No	Point Size	Nominal Square Size	L	
			mm	in
A3R1/8-2.75	2	1/8"	70	2.76
A3R9/64-2.75	3	9/64"	70	2.76

Square Recess Insert Bits

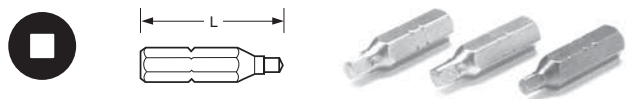

Part No	Point Size	Nominal Square Size	L	
			mm	in
A38R1/8-1	2	1/8"	25	0.98
A38R9/64-1	3	9/64"	25	0.98

Slotted Insert Bits

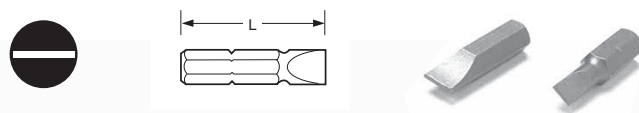

Part No	Screw Size	L		Blade Thickness	Blade Width
		mm	in		
A38M8-1	8	25	0.98	0.04	0.25
A38M10-1	10	25	0.98	0.05	0.28

Phillips Double-Ended Power Bits

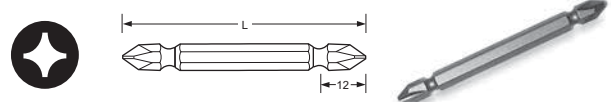

Part #	Size	L	
		mm	in
A3W1-3	1	75	2.94
A3W2-2	2	50	1.97
A3W2-3	2	75	2.94
A3W2-4	2	100	3.94
A3W2-6	2	150	5.91
A3W2-8	2	200	7.87
A3W2-10	2	250	9.84
A3W2-12	2	300	11.81
A3W3-2	3	50	1.97
A3W3-3	3	75	2.94
A3W3-4	3	100	3.94
A3W3-6	3	150	5.91
A3W3-8	3	200	7.87

BITS & SOCKETS

Slotted Power Bits

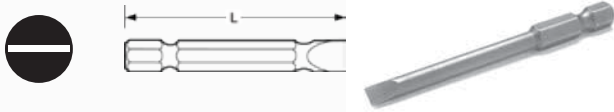

Part #	Screw Size	mm	L in	Blade Thickness	Blade Width
A3M8-3	8	75	2.95	0.04	0.28
A3M10-3	10	75	2.95	0.05	0.31

Torx Power Bits

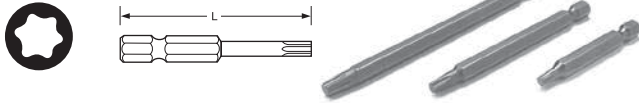

Part #	Torx Size	mm	L in
A3T6-2	T6	50	1.97
A3T7-2	T7	50	1.97
A3T7-2.75	T7	70	2.76
A3T7-3.5	T7	90	3.54
A3T7-6	T7	150	5.91
A3T8-2	T8	50	1.97
A3T9-2.75	T9	70	2.76

Bit Holders



Part #	MM	L IN
1/4" Hex, Magnetic		
A3BHM-3	75	2.94
A3BHM-4	100	3.94
A3BHM-6	150	5.91
A3BHM-8	200	7.87
A3BHM-10	250	9.84

Bit and Nutsetter Part Number Nomenclature

Precedes Part Number

BITS		A7	7/16 Power Drive
A3S	Phillips® Power Drive	AS	Electric Type Phillips®
A3W	Double Ended Phillips®	AM	Electric Type Slotted
A38S	Phillips® Insert	ATW	Electric Type Tri-Wing®
A39S	Phillips® Insert Reduced Nose	AT	Electric Hios Type Torx®
A3M	Slotted Power Drive	A26S	Electric Driver Phillips®
A38M	Slotted Insert	A26M	Electric Driver Slotted
A3MT	Slotted Power Drive Reduced Nose	A26C	Electric Driver Allen Socket Head
A3C	Allen Socket Head Power Drive	A3BHM	Insert Bit Holder (Magnetic Type)
A38C	Allen Socket Head Insert	A3BHD	Insert Bit Holder (Non Magnetic)
A3R	Square Recess Power Drive	NUTSETTERS	
A3RT	Square Recess Turned Down (Power)	A3B	Nutsetter
A38R	Square Recess Insert	A3BMP	Magnetic (MP) Pressed Type
A3T	Torx® Power Drive	A3BMS	Magnetic (MS) Spring Loaded
A38T	Torx® Insert	A3BMT	Magnetic (MT) Tube Type
A3TS	Torq-Set® Power Drive	A3BU	Universal Nutsetter
A38TS	Torq-Set® Insert	MAG-O-NETS	
A3TA	Triangle Power Drive	AM	AIMCO Mag-O-Net®
A3TW	Tri-Wing® Power Drive		
A38TW	Tri-Wing® Insert		

Contained within Part Number

Bits		ACRB	ACR® 4x4 Both Install and Remove
PZ	Pozidriv®	E4	Electric 4mm diameter
PZACR	Pozidriv® ACR®	E5	Electric 5mm diameter
SDV	Supadriv®	RS	Reduced Shank
TR	Torx® Tamper Resistant		
ACRI	ACR® Installation		
ACR	ACR® Remove		

Additional types and sizes of fastener tools, as well as custom parts, are available upon request. Contact an Eagle Group Customer Service Associate at (503) 254-6600, or toll free (800) 852-1368.

RESOURCES

RESOURCES

WARRANTY INFORMATION

NEW TOOL AND ACCESSORY WARRANTY

Any new tool or accessory branded with the Eagle name, and purchased from EAGLE GROUP (EAGLE), or through one of its authorized distributors or agents, is warranted to the original buyer against defects in materials and workmanship for a period of one (1) year* from date of delivery. Under the terms of this warranty, EAGLE GROUP will repair or replace any product or accessory warranted hereunder and returned freight prepaid proving to EAGLE GROUP's satisfaction to be defective as a result of workmanship or materials. In order to qualify for this warranty, written notice to EAGLE GROUP must be given immediately upon discovery of such defect, at which time EAGLE GROUP will issue an authorization to return the tool. The defective item must be promptly returned to an authorized EAGLE GROUP service center with all freight charges prepaid.

REPAIRED TOOL WARRANTY

Once a tool is beyond the new product warranty period, as detailed above, EAGLE GROUP will provide repair warranty on pneumatic tools for a period of 90 days* beyond the warranted repair date.

EXCLUSION FROM WARRANTY

This warranty is valid only on products purchased from EAGLE GROUP, or thru its authorized distributors or agents. EAGLE GROUP shall have no obligation pursuant to the EAGLE GROUP Warranty with respect to any tools or accessories which in EAGLE GROUP's sole judgment have been altered, damaged, misused, abused, badly worn, lost or improperly maintained. This Warranty is null and void if the customer, or any other person other than an authorized representative of EAGLE GROUP, has made any attempt to service or modify the tool or accessory prior to its return to EAGLE GROUP under this Warranty.

The warranty provision with respect to each such product may be amended by EAGLE GROUP from time to time in its sole discretion. The liability of EAGLE GROUP hereunder shall be limited to replacing or repairing, at its option, any products which are returned freight prepaid to EAGLE GROUP and which EAGLE GROUP determines to be defective as described above or, at EAGLE GROUP's option, refunding the purchase price of such products.

EAGLE GROUP reserves the right to make periodic changes in construction or tool design at any time. EAGLE GROUP specifically reserves the right to make these changes without incurring any obligation or incorporating such changes or updates in tools or parts previously distributed.

THE EAGLE GROUP WARRANTY IS IN LIEU OF ALL OTHER WARRANTIES, EXPRESSED OR IMPLIED, AND EAGLE GROUP EXPRESSLY DISCLAIMS ANY WARRANTY OF MERCHANTABILITY OR FITNESS FOR A PARTICULAR PURPOSE. THIS WARRANTY SETS FORTH THE SOLE AND EXCLUSIVE REMEDY IN CONTRACT, TORT, STRICT LIABILITY, OR OTHERWISE.

THIS WARRANTY IS THE ONLY WARRANTY MADE BY EAGLE GROUP WITH RESPECT TO THE GOODS DELIVERED HEREUNDER, AND MAY BE MODIFIED OR AMENDED ONLY BY A WRITTEN INSTRUMENT SIGNED BY A DULY AUTHORIZED OFFICER OF EAGLE GROUP.

LIMITATION OF LIABILITY

EAGLE GROUP'S LIABILITY PURSUANT TO WARRANTY OF THE PRODUCTS COVERED HEREUNDER IS LIMITED TO REFUND OF THE PURCHASE PRICE. IN NO EVENT SHALL EAGLE GROUP BE LIABLE FOR COSTS OF PROCUREMENT OF SUBSTITUTE GOODS BY THE BUYER. IN NO EVENT SHALL EAGLE GROUP BE LIABLE FOR ANY SPECIAL, CONSEQUENTIAL, INCIDENTAL OR OTHER DAMAGES (INCLUDING WITHOUT LIMITATION, LOSS OF PROFIT) WHETHER OR NOT EAGLE GROUP HAS BEEN ADVISED OF THE POSSIBILITY OF SUCH LOSS, HOWEVER CAUSED, WHETHER FOR BREACH OR REPUDIATION OF CONTRACT, BREACH OF WARRANTY, NEGLIGENCE OR OTHERWISE. THIS EXCLUSION ALSO INCLUDES ANY LIABILITY WHICH MAY ARISE OUT OF THIRD PARTY CLAIMS AGAINST BUYER. THE ESSENTIAL PURPOSE OF THIS PROVISION IS TO LIMIT THE POTENTIAL LIABILITY OF EAGLE GROUP ARISING OUT OF THIS AGREEMENT AND/OR SALE.

Note: The EAGLE GROUP Warranty confers specific legal rights, however some states or jurisdictions may not allow certain exclusions or limitations within this warranty.

* All warranty periods addressed herein are determined using a standard shift, eight-hour work day.

EAGLE GROUP

Attn: Service Department
10000 SE Pine Street
Portland, OR 97216
800.852.1368



AIMCO CORPORATE HEADQUARTERS

10000 SE Pine Street
Portland, Oregon 97216
Phone: (503) 254-6600
Toll Free: (800) 852-1368

AIMCO CORPORATION DE MEXICO SA DE CV

Ave. Cristobal Colon 14529
Chihuahua, Chihuahua. 31125
Mexico
Phone: (01-614) 380-1010
Fax: (01-614) 380-1019